

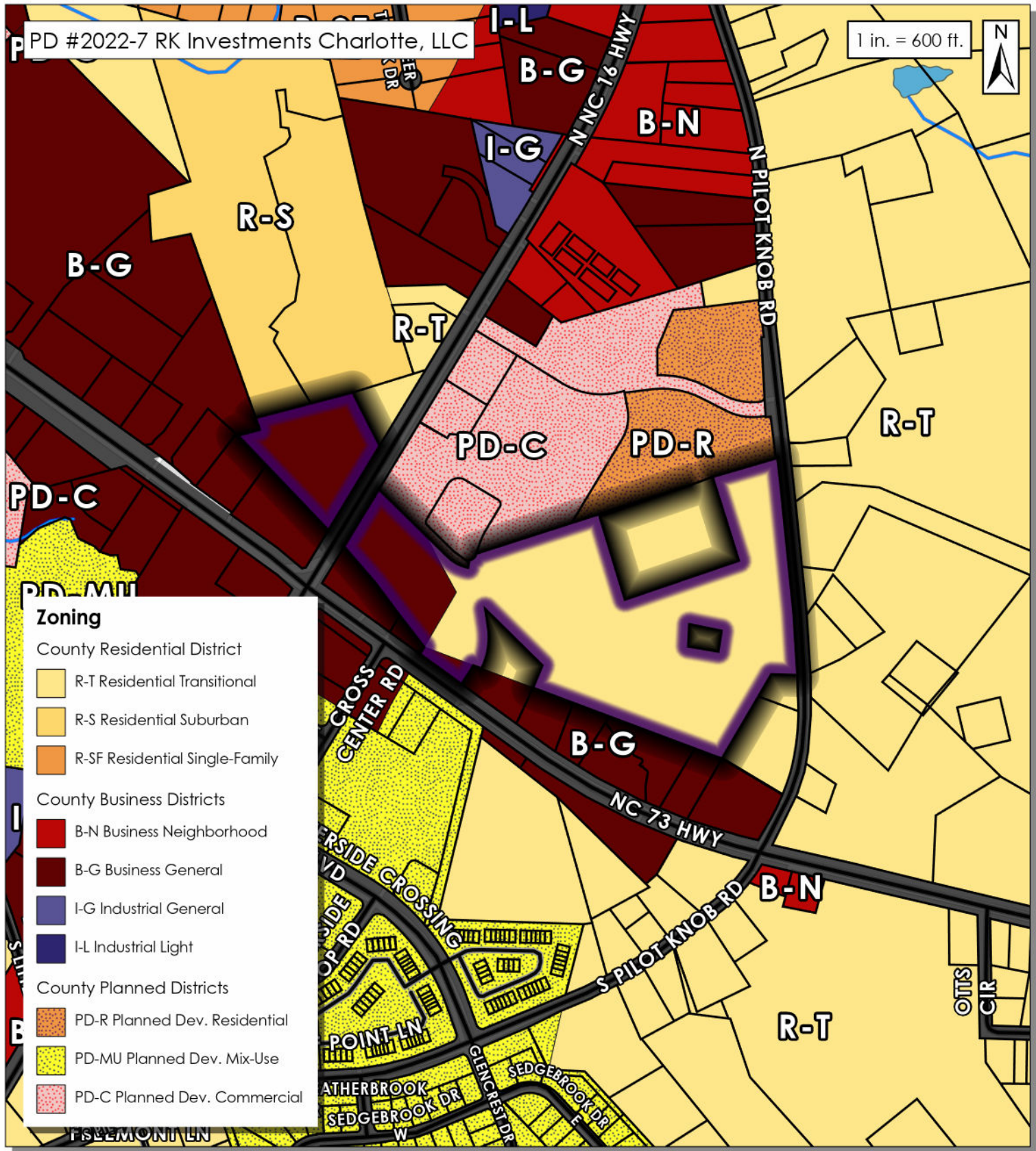

PD #2022-7 RK Investments Charlotte, LLC

1 in. = 600 ft.



Zoning

County Residential District

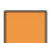
-  R-T Residential Transitional
-  R-S Residential Suburban
-  R-SF Residential Single-Family

County Business Districts

-  B-N Business Neighborhood
-  B-G Business General
-  I-G Industrial General
-  I-L Industrial Light

County Planned Districts

-  PD-R Planned Dev. Residential
-  PD-MU Planned Dev. Mix-Use
-  PD-C Planned Dev. Commercial

Parcel ID # 34534

 - Property Location(s)

See Attached Application for Parcel Information

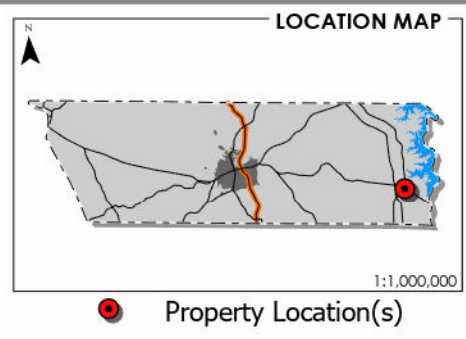

Lincoln County
 Planning & Inspections
 115 W. Main St
 3rd Floor
 Lincolnton, NC 28092

 Property Location(s)